

SUPERIOR
HARDWOOD FLOORING

SUPERIOR ENHANCED

superiorflooring.ca



IT ALL STACKS UP TO EXCELLENCE

Superior's Enhanced Hardwood is the only 3-ply engineered product available on the market containing a quarter-sawn solid hardwood core and base. Enhanced features a 4mm hardwood wear layer with a core and base layer consisting of 100% rift & quartered hardwood for ultimate durability. The woven internal structure reduces warping, ensuring a consistent flat surface. Enhanced Hardwood is crafted from an innovative method providing a more stable product than common 2-ply or plywood based systems.

TEXTURE	SHEEN	LEVEL
Smooth	Matte	5%, 10%*
	Low Sheen	25%
	Semi-Gloss	50%
Wirebrushed	Matte	5%, 10%*
Handscraped	Matte	5%, 10%*

*Matte sheen depends on colour/finish selected.
Some colours and grades may not be available, please refer to our website or availability charts for available configurations.

RECOMMENDED MOISTURE CONTENT, RELATIVE HUMIDITY, AND TEMPERATURE RANGE

Temperature		Relative Humidity (Percent)							
°F	°C	25	30	35	40	50	55	60	65
50	10	5.5	6.3	7.1	7.9	9.5	10.4	11.3	12.4
60	15	5.4	6.2	7.0	7.8	9.4	10.2	11.1	12.1
70	21	5.4	6.2	6.9	7.7	9.2	10.1	11.0	12.0
80	26	5.3	6.1	6.8	7.6	9.1	9.9	10.8	11.7
90	32	5.1	5.9	6.7	7.4	8.9	9.7	10.5	11.5

We do not recommend acclimation of any of our products. Our Engineered hardwood should only be installed in "normal living conditions" 30% to 65% RH. Please consult our warranty and installation guidelines for more information.



SPECIES AVAILABLE

Maple
Hickory
White Oak



BOARD LENGTHS

Random board lengths
ranging from
10" to 90"



BOARD WIDTHS

6" | 7"

BOARD THICKNESS

3/4"



AVAILABLE GRADES

Premier
Select
Heritage



ENHANCED INSTALL DETAILS

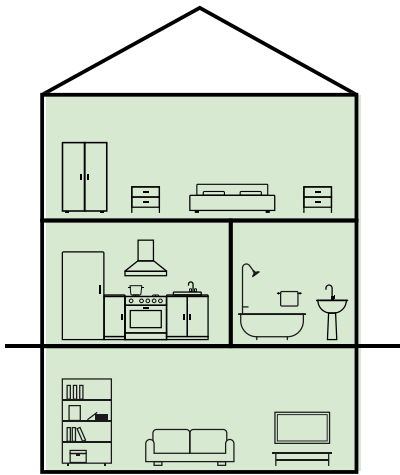

ACCEPTED INSTALLATION LOCATIONS

- Above Grade
- On Grade
- Below Grade
- Radiant Heat Friendly
(select species/sizes not recommended see our radiant heat guide.)

INSTALLATION METHODS

- Cleats, staples, floating, or glue-down.
- Wood subfloors
- Concrete subfloors.

APPROVED UNDERLAYS

We recommend Silicone impregnated paper (i.e: **All Globe**) or Laminated Kraft paper and asphalt (i.e: **Fortifiber Aquabar B**)



PACKAGING SPECIFICATIONS

PRODUCT DIMENSIONS	SQFT PER BOX	SQFT PER SKID	BOXES PER SKID	LBS PER BOX
6" (152mm) x 3/4" (19mm)	22	660	30	65-70
7" (178mm) x 3/4" (19mm)	25.5	637.5	25	65-75

SUPERIOR'S WATER CLEAR™ FINISH

Our commitment to environmental excellence governs how we finish our products. There are virtually no volatile organic compounds (VOC's) emitted from our Water Clear™ Finish during the application process or afterwards. It is free of formaldehyde, isocyanate or other hazardous air pollutants. Water Clear™ Finish is cured by UV light and is 100% reactive which means that they don't significantly contribute to ground level air pollution.

- ✔ Virtually no VOC's
- ✔ Water based stains
- ✔ Wood absorbs the stain colour which enhances the features of the natural wood
- ✔ Ensures a superior product as any flaws would be apparent in our flooring

INCREDIBLE
35 YEAR
FINISH WARRANTY



NORTH
AMERICAN
MADE



PROUD MEMBER OF THE
NATIONAL WOOD FLOORING
ASSOCIATION

